

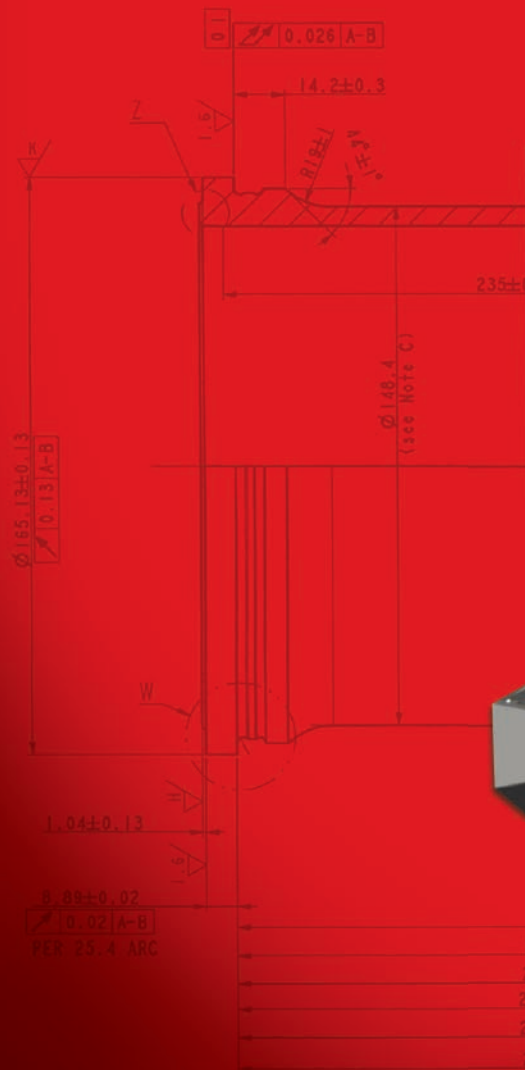

ABOVE AND BEYOND HONING

SVL-2115

PRECISION VERTICAL LAPPING SYSTEM



SUNNEN'S SVL-2115 LAPPING MACHINE: INCREASES PRODUCTIVITY AND PARTS CONSISTENCY



Sunnen's SVL-2115 automated lapping machines bring increased safety, productivity, and part consistency to what is traditionally a manual process. The SVL-2115 is based on the same machine platform as the proven SV-2100 honing system and provides single setup processing of aerospace hydraulic control valve sleeves, fuel system components and other parts that are prone to distortion when honed.

The Sunnen lapping system handles workpiece diameters from 7.9 to 20 mm (0.311 to 0.787in) and lengths up to 12 times the bore diameter, not to exceed 200 mm (7.87 in).

TENCY

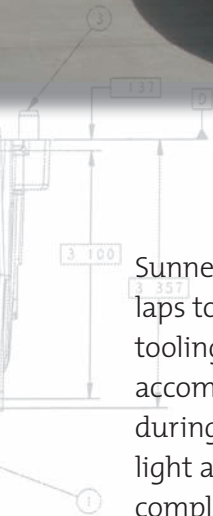
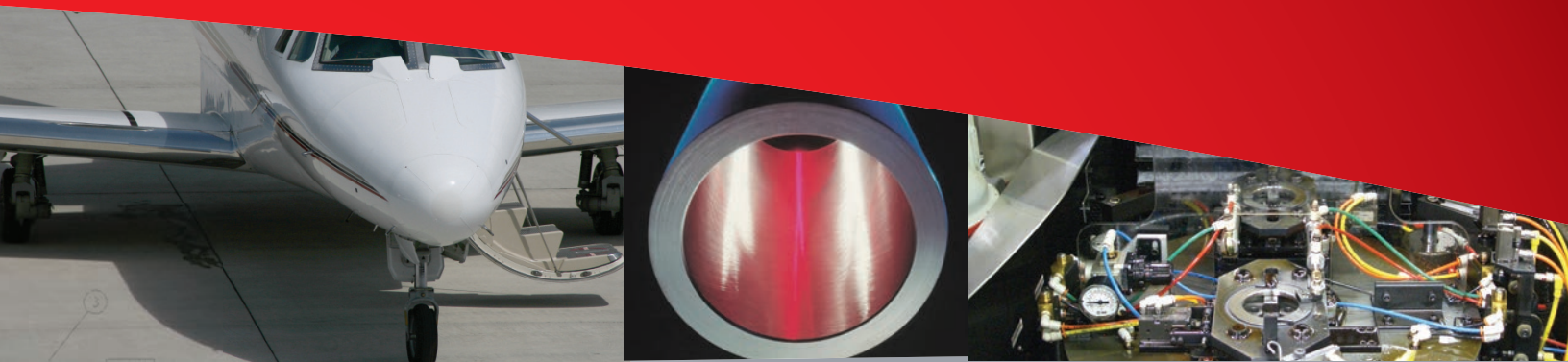

Sunnen has developed patent pending lapping laps to accompany this system. Easy tooling and probe changeovers accommodate frequent part changes during the course of a shift. A stack light allows operators to monitor cycle completions or faults from a distance. The lapping system is available with Sunnen's new SVF-15 filtration system.

Sunnen's SVL-2115 is built in the USA and backed by Sunnen, the world wide leader in precision bore sizing and finishing.



Your Sunnen Technical Specialist will work with you to determine the best solution for your needs – it's all part of the added value you get with Sunnen. Plus, our worldwide sales and service team provides comprehensive support for the installation and operation of every system we make.

Whatever your need, we have the expertise and product range to create the right solution for you and the dedication to support you for the long run.

*To find the Sunnen representative nearest you, visit our website:
www.sunnen.com*



THE SVL-2115 LAPPING MACHINE BRINGS INCREASED PRODUCTIVITY AND PART CONSISTENCY

STANDARD & OPTIONAL FEATURES

- SVL-2115 base machine includes single spindle, lapping module, base part fixture, air gage column, and servo index table. Part fixture nest, lap expander/retractor and air gage probes/master rings must be ordered separately.
- Low maintenance stainless steel enclosure provides good visibility and ensures operator safety.
- “Lubed-for-life” over-sized stroke guideways ensure superior performance and long, trouble-free life.
- Precision 1.5 kW (2HP) servo spindle.
- Advanced servo ball screw stroke control.
- Flexible modular design allows custom machine configurations to optimize part processing.
- Rugged, solid cast polymer composite base reduces vibration for enhanced performance and precision.
- Cast iron column for increased rigidity and optimum precision.
- Latest in safety technology with safety PLC and safe drive systems; interlocked doors, light curtain and dual palm button cycle start
- Standard LED work area lighting.
- Standard automatic stroker lube system
- Standard machine status light



OTHER FEATURES & OPTIONS:

CUSTOM PART FIXTURING



CUSTOM AIR-GAGING

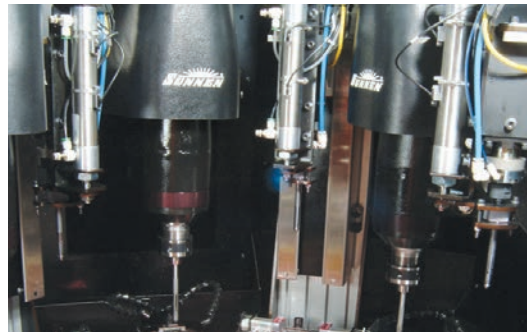

CUSTOM ROBOTIC PARTS HANDLING





OPERATOR INTERFACE & SOFTWARE FEATURES

- Patent pending easy-to-use Windows®-based PC touch screen control system provides optimum process control with ease of set-up. (Large 482 mm - 19 in - touch screen)
- Stock removal mode minimizes lapping cycle time
- Spindle speed and column speed can be varied as needed.
- Automation interface provides seamless automation integration: robotic interface for loading and unloading; pneumatic interface for easy fixture integration.
- Multiple setups can be entered and saved for future production runs of the same components.
- State-of-the-art electronics with touch screens and hand wheel controls reduce setup time and increase machine “up time.”
- Multiple languages available.
- USB Port for ease of system backup/update.

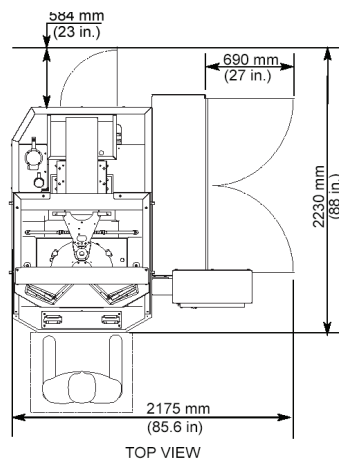

SVL-2115 FLOOR PLAN LAYOUT

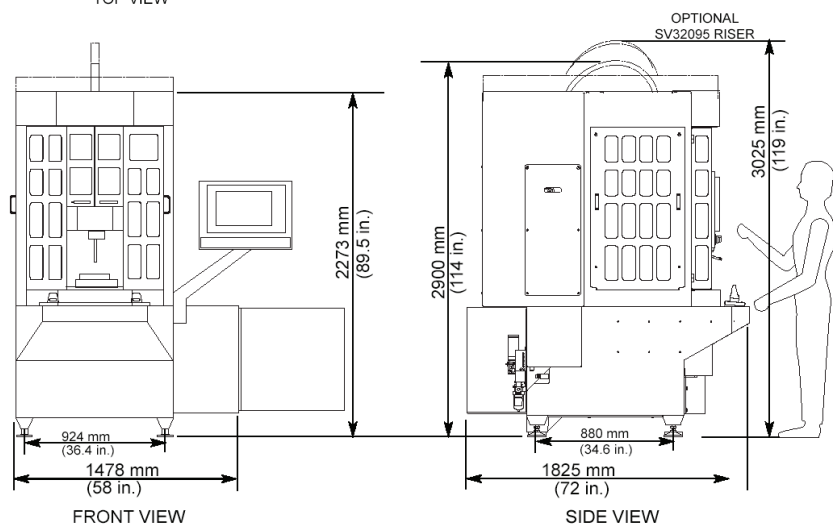

CUSTOM FIXTURES & TABLE CONFIGURATIONS

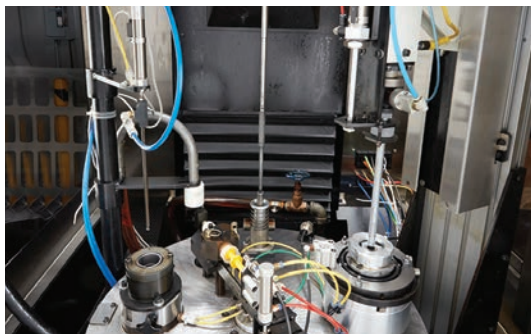



CUSTOMIZE YOUR SYSTEM TO YOUR EXACT REQUIREMENTS

Sunnen's high-precision bore sizing systems represent the very finest solutions available anywhere in the world. They are reliable, durable, and flexible systems designed to deliver the production quality and precision our customers have grown to expect.

From design to delivery, you have the Sunnen commitment to service and quality assurance. Our technical experts will work with you to determine the number of spindles, style of tooling, fixturing, abrasives, in-process and/or post-process gaging, and method of parts loading and unloading (including robotics) you require. Then we'll provide you a written proposal.

After your system is built, we'll set up a live run-off demonstration at our facility. Once it meets all specifications, we'll commission your system and train your staff.

AUTOMATION OPTIONS



A TWO-AXIS OR MULTI-AXIS SERVO ROBOT CAN BE INTEGRATED INTO A SUNNEN MODULAR SYSTEM.

Our automation options are designed to increase the operational efficiency of your precision system. They shorten cycle times, increase tool life, and – most importantly – radically reduce labor costs. Sunnen automation solutions can keep your system running 24 hours a day, seven days a week.

SPECIFICATIONS:

WORKPIECE DIAMETER RANGE:

7.9 to 20 mm (.311 to .787 in)

WORKPIECE BORE LENGTH RANGE

Up to 12 times bore diameter, not exceeding 200 mm (7.874 in)

SPINDLE SPEED RANGE:

100 - 2000 rpm during lapping

SERVO SPINDLE MOTOR:

1.5 kW (2 HP)

CARRIAGE TRAVEL:

630 mm (24.8 in)

RECIPROICATION RATE (STROKE):

0 - 350 spm

SERVO STROKER MOTOR: 7,5 kW (10 hp)

COOLANT SUMP PUMP:

Centrifugal Pump: 27 kW (.36 hp)

80 LPM (20 GPM)

(Separate Coolant System Required)

FLOOR SPACE

(COOLANT SYSTEM NOT INCLUDED):

2175 W x 2230 D x 2900 H mm

(83 x 86 x 114 in.)

FLOOR WEIGHT:

2154 kg (4750 lbs.)

FLOOR LOAD: 2050 kg/sq. meter

(415 lbs./sq. ft) (SVL-2115)

PNEUMATIC REQUIREMENTS: 5,5 to 6,9 Bar

(80 to 100 psi) required. Filter regulator

included with base machine.

ELECTRICAL REQUIREMENTS:

460V, 60Hz, 3Ph

400V, 50Hz, 3Ph

* DIAMETER RANGE, LENGTH RANGE AND WORKPIECE WEIGHT ARE CONTINGENT ON WORKPIECE AND APPLICATION.

STANDARD MACHINE OPTIONS:

- SVF-15 Coolant systems
- Automation PLC
- Robot interface
- MMT-SC1 17 mm MMT collet
- MMT-SC2 23 mm MMT collet
- MMT-SC3 25 mm MMT collet



Custom designed lapping arbor and sleeve (left). Closeup of SVL-2115 fixture with lapping tool.

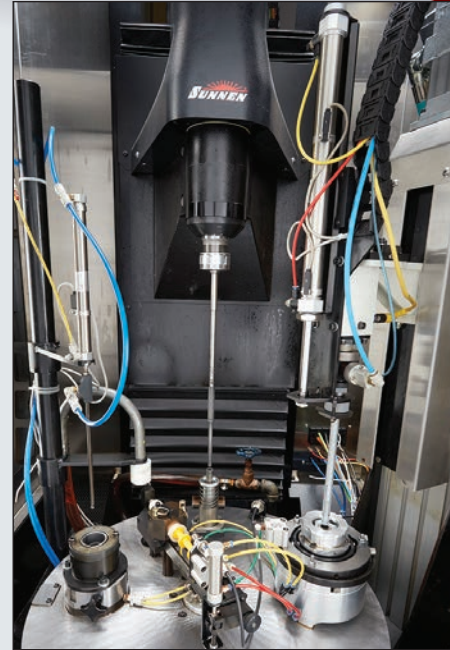

TOOLING

The SVL-2115 incorporates the latest technology in vertical bore lapping. Patent pending lapping tools are custom-designed to meet your bore diameter and length requirements and to work with Sunnen's novel feed system.

SVF-15 Grit Guard® Coolant Filter (below) is optional on the SVL-2115 lapping system. The filter is available in both 208 liter (55 gallon) and 416 liter (110 gallon) models.



LAPPING PASTE

For Sunnen's Lapping System, specially blended pastes of superabrasives and conventional abrasives are available for each application. These pastes are provided in containers that plug into the applicator and eliminate the mess and inconsistency that comes from having operators mix their own.

GET THE PRECISION YOU NEED WITH SUNNEN PREMIUM CUTTING FLUIDS

Sunnen's premier line of oil and waterbase cutting fluids for honing, superfinishing, and lapping increasing cutting rates while reducing abrasive consumption. Delivering faster lower cost per part processes leads to more profits.



A LEGACY OF EXCELLENCE SINCE 1924.

WORLDWIDE

Our global manufacturing, distribution, and sales and service network allows us to deliver quality Sunnen solutions worldwide.

And our state-of-the-art Technical Services Centers allow our technical experts to develop innovative solutions to customer application challenges. The Centers also provide answers for customer questions and training for Sunnen representatives around the world.

SUNNEN PRODUCTS COMPANY WORLD HEADQUARTERS St. Louis, MO – USA

Phone 1.314.781.2100
Fax 1.314.781.2268
Toll Free 1.800.325.3670
Email sunnen@sunnen.com
www.sunnen.com



AUSTRIA - SUNNEN AUSTRIA GMBH HOHENEMS

Phone +43 5576 74194
Fax +43 5576 74196
Email sales@sunnen.eu
www.sunnen.at

BELGIUM - SUNNEN BENELUX BVBA KONTICH

Phone +32 38 80 2800
Fax +32 38 44 3901
Email info@sunnen.be
www.sunnen.be

BRAZIL - SUNNEN DO BRASIL LTDA. SÃO PAULO

Phone +55 11 4177-3824
Fax +55 11 4362-3083
Email sunnen@sunnen.com.br
www.sunnen.com.br

CHINA - SHANGHAI SUNNEN MECHANICAL Co. LTD. SHANGHAI

Phone +86 21 5813 3990
FAX +86 21 5813 2299
Email shsunnen@sunnensh.com
www.sunnensh.com

CZECH REPUBLIC - SUNNEN S.R.O. STRAKONICE

Phone +420 383 376 317
Fax +420 383 376 316
Email sunnen@sunnen.cz
www.sunnen.cz

FRANCE - SUNNEN SAS SACLAY

Phone +33 169 30 00 00
Fax +33 169 30 11 11
Email info@sunnen.fr
www.sunnen.fr

INDIA - SUNNEN INDIA PVT. LTD. MUMBAI

Phone +91 223 913 6055
Fax +91 223 913 6056
Email sales@sunnen.in
www.sunnen.in

ITALY - SUNNEN ITALIA S.R.L. ARESE

Phone +39 02 383 417 1
Fax +39 02 383 417 50
Email sunnen@sunnenitalia.com
www.sunnenitalia.com

POLAND - SUNNEN POLSKA SP. Z O.O. WARZAWA

Phone +48 22 814 34 29
Fax +48 22 814 34 28
Email sunnen@sunnen.pl
www.sunnen.pl

RUSSIA - SUNNEN RUS LLC MOSCOW

Phone +7 495 258 43 43
Fax +7 495 258 91 75
Email sunnen@sunnen-russia.ru
www.sunnen.ru

SWITZERLAND - SUNNEN AG ENNETAACH

Phone +41 71 649 33 33
Fax +41 71 649 33 34
Email sales@sunnen.eu
www.sunnen.eu

UK - SUNNEN PRODUCTS LTD. HEMPSTEAD HERTS

Phone +44 1442 39 39 39
Fax +44 1442 39 12 12
Email hemel@sunnen.co.uk
www.sunnen.co.uk

Sunnen reserves the right to change or revise specifications and product design in connection with any feature of our products contained herein. Such changes do not entitle the buyer to corresponding changes, improvements, additions, or replacements for equipment, supplies or accessories previously sold. Information contained herein is considered to be accurate based on available information at the time of printing. Should any discrepancy of information arise, Sunnen recommends that user verify the discrepancy with Sunnen before proceeding.